

Make
A
Difference
卓/尔/不/凡

REFRIGERATOR BFC 96/96DC



压缩机冰箱
安装和使用说明书 **CN**

Compressor Refrigerator
Installation and Operating Instructions **EN**







非常感谢您选购**阿雷纳**的制冷设备，在安装或使用冰箱之前，请您仔细阅读此说明书。请将说明书保存在所有用户都可以找到的地方，以便随时查阅使用。如果该冰箱转让或者出售，请确保此说明书也交付给新用户，以便告知他们安装方法、使用和安全要求。

目录

1.0 安全符号说明	3
2.0 安全说明	3
2.1 一般性安全说明.....	4
2.2 操作安全说明.....	4
3.0 预期用途	5
4.0 技术描述	5
5.0 装饰面板的安装	6
6.0 冰箱的安装和连接	7
6.1 冰箱的安装.....	11
6.2 连接直流电源.....	11
6.3 连接交流电源.....	12
7.0 冰箱的使用	12
7.1 冰箱开机.....	13
7.2 设置温度.....	13
7.3 运行模式设置.....	14
7.4 故障报警.....	14
7.5 搁物架取出.....	14
7.6 左右开门更换.....	16
7.7 关机和存放.....	19
8.0 清洁和维护	21
9.0 技术参数	22
10.0 故障排除	23
11.0 零部件明细表	24
12.0 质量保证	29

1.0 安全符号说明

-  **危险!** 表示潜在的危险情况，会导致死亡或重伤
-  **警告!** 表示潜在的危险情况，会导致轻伤或重度损伤
-  **注意!** 表示潜在的危险情况，会导致财产损失
-  **提示** 产品操作的补充信息

2.0 安全说明

- 仅在此说明书中描述的用途下使用该产品。
- 该产品在使用之前必须按照说明书的指示进行正确安装。
- 在电器连接线缆破损或者磨损时，必须由专业人员马上维修更换。一定不能使用有裂纹、磨损的线缆、插头或者连接端点，以防安全隐患。
- 在清洗或者维修时必须将机器断电。
- 不能在有易燃气体的环境中使用该产品。
- AC 电源必须可靠接地。
- 不能使用改制的插头或者自行延长的线缆。

注意!

因制冷系统内有一定的压力和制冷剂溶液，请不要自行打开制冷系统；不论任何原因需要维修时，我们强烈要求您请专业的维修人员进行维修操作。

以下情况造成的损坏，**阿雷纳**不承担任何责任：

- 错误装配或连接。
- 机械影响和过电压造成产品损坏。
- 未取得制造商明确许可擅自改变产品。
- 用于此说明书规定之外的用途。

2.1 一般性安全说明

警告!

- 仅适合专业人员维修该冰箱。
- 不恰当维修可导致更严重的损坏。
- 如冰箱有明显的损坏，请勿操作该冰箱。
- 对于 12 岁及以上儿童以及生理、感官、精神能力受限或者缺乏知识和经验的人，在对其进行监督或已告知如何安全使用冰箱以及可能存在的危险的前提下，他们可以使用该冰箱。
- 在没有监督的情况下，不得由儿童进行操作、清洗和维护。
- 小心挤伤！请勿将手指放入铰链中。
- 食品只能贮存在其原有包装或合适的容器中。

注意!

- 检查铭牌上的电压是否与电源的电压一致。
- 冰箱不适于贮存腐蚀性或含溶剂的物质。
- 冰箱用在房车或游船上，与直流电源连接时，如果长期不用，请关闭总电源开关，防止电瓶亏电。

2.2 操作安全说明

危险!

- 不要徒手触摸裸露的电线，尤其是当冰箱连接交流电源运行时。

注意!

- 启动冰箱前，确保电源线和插头的干燥性。
- 不得将冰箱安装在靠近明火或其它热源（加热器、阳光直射、煤气炉等）的地方。
- **过热危险!** 请始终保持冰箱周围足够的通风，以便消散冰箱工作期间所产生的热量。

- 冰箱顶部**通风格栅**不能被任何物品堵塞、遮盖。
- 防止冰箱和电线受热和受潮。
- 确保食物不会触及制冷区的任何内壁。

3.0 预期用途

- 该冰箱适用于安装在房车和船上，也可用于家用。
- 该冰箱适用于安装在固定的壁橱内，一旦安装好，只有冰箱的前面是可接触到的。
- 该冰箱只适用于冷藏、冷冻和储存食物。该冰箱不适用于药品的储存。

警告!

- 请检查该冰箱的制冷能力是否适合存放您想要储存的食品。

4.0 技术说明

- 该冰箱上面为冷冻室，下面为冷藏室。
- 该冰箱为交直流两用冰箱，可以在 12V DC，24V DC 以及 100-240V AC 条件下工作。
- 冰箱内使用的所有材料均符合食品级；制冷剂回路免维护。
- 在最大倾角为 30°的情况下，冰箱也能正常工作。
- 冰箱控制面板调节的是冷藏室内的温度。

注意!

请确保接入冰箱的电源极的正确性。

- 初次启动冰箱前，先检查冰箱的工作电压是否与电池电压相匹配（见铭牌）。
- 冰箱连接至直流电时：线路须有最大 15 A（12 V 时）或 7.5 A（24 V 时）的保险丝保护。
- 冰箱连接至交流电时：线路须有最大 4 A（220 V 时）的保险丝保护。
- 连接 DC 直流电源时：直流电源线红色线连接电池的正极，白色线连接电池的负极。
- 连接 AC 交流电源时：插座必须正确的接地并配置保险丝保护。

5.0 装饰面板的安装

- 在安装冰箱前，应先在冰箱门上安装装饰面板。
- 装饰面板的厚度必须小于或等于 4mm。
- 上门板尺寸是 408mm 宽，242mm 高；下门板尺寸是 408mm 宽，655mm 高。

01

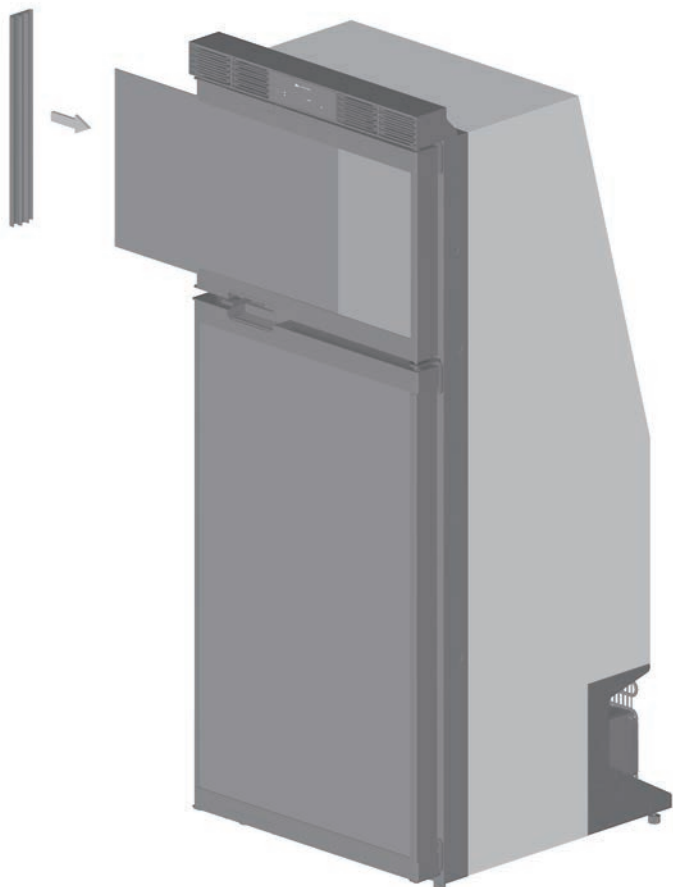

6.0 冰箱的安装和连接

CN

02

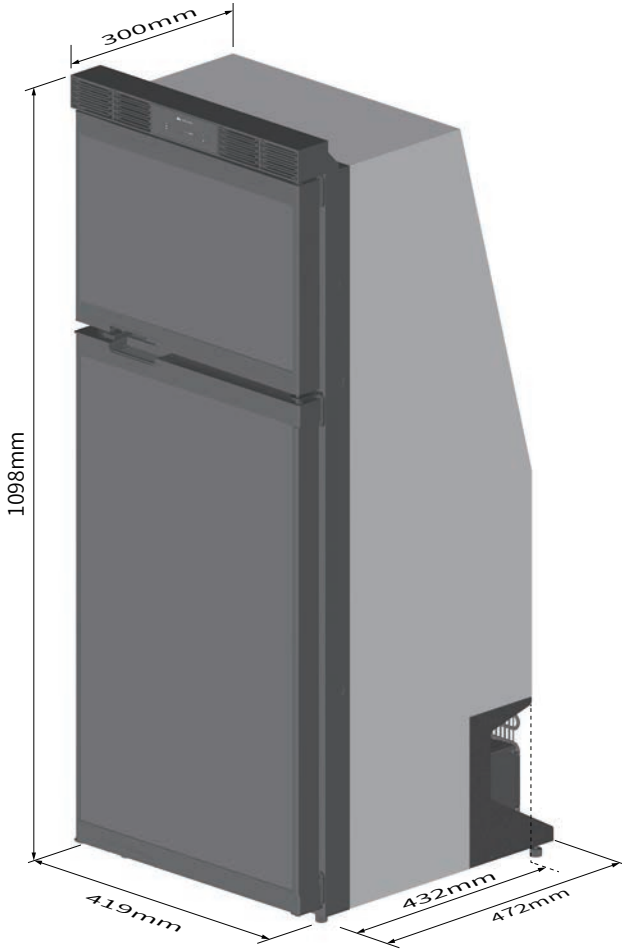

03

CN

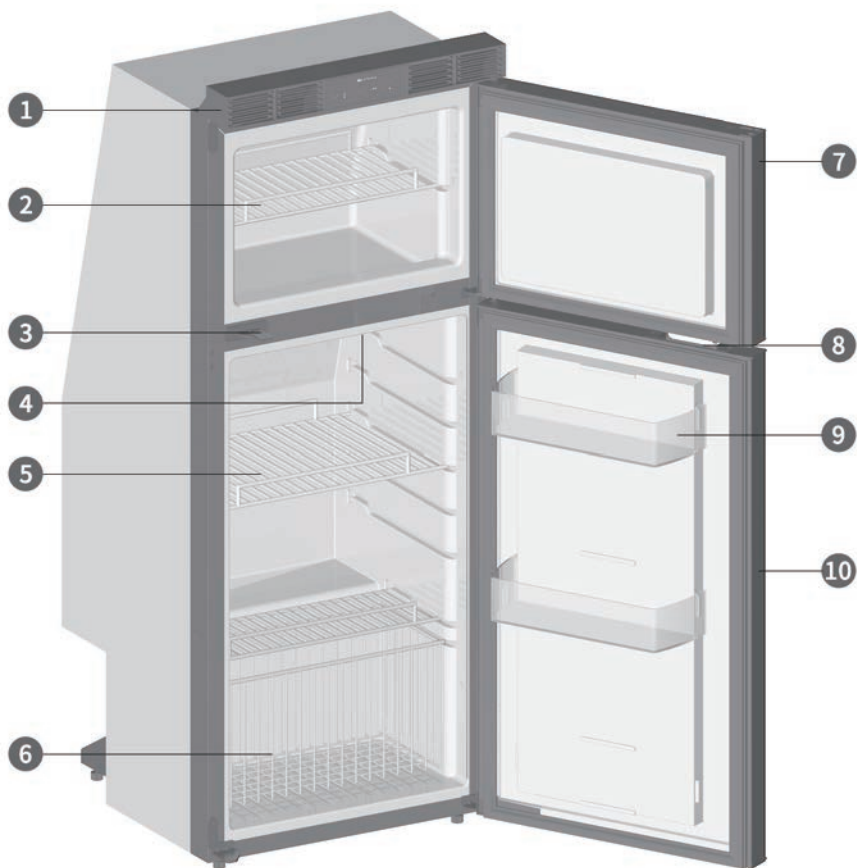

1	通风格栅	6	果蔬筐
2	冷冻室搁物架	7	冷冻室门体
3	锁挡块	8	把手
4	内置灯	9	挂盒
5	冷藏室搁物架	10	冷藏室门体

04

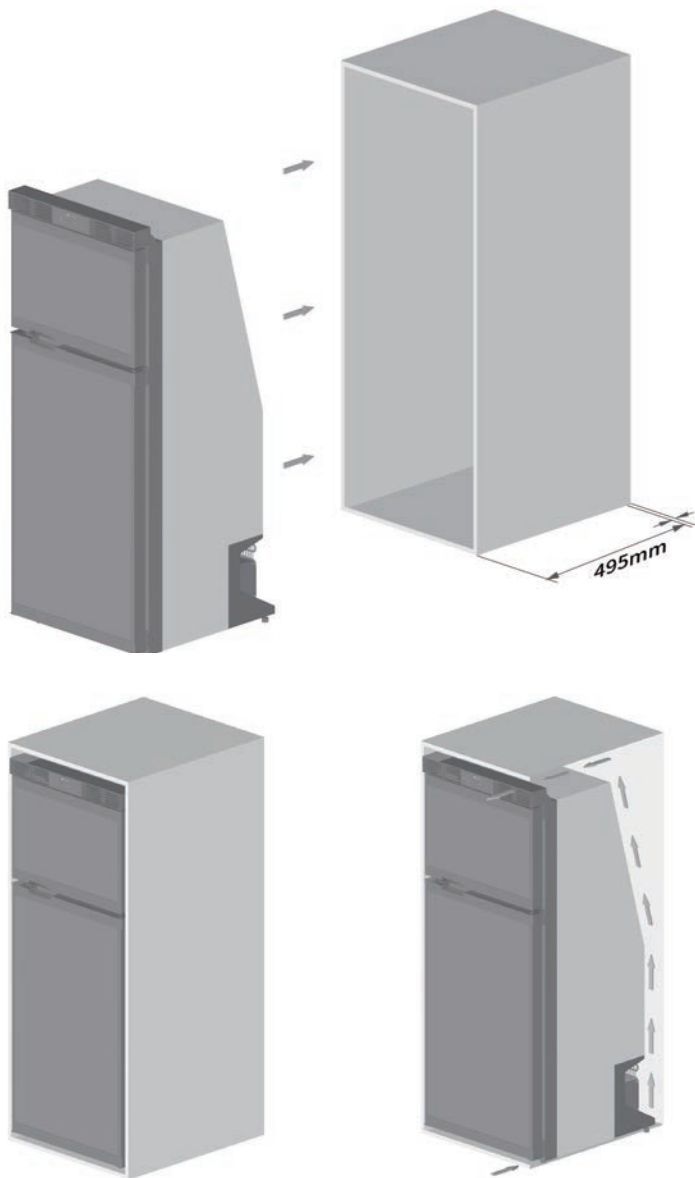

CN

05

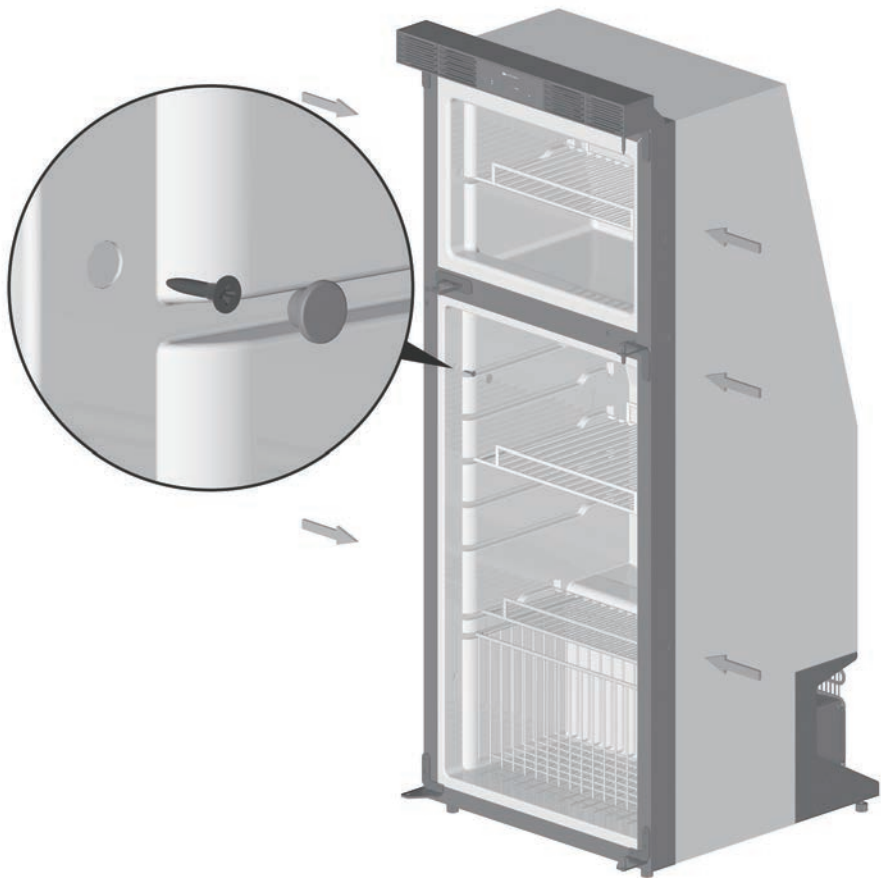

6.1 冰箱的安装

安装前，请见如下说明：

危险!

- 如果冰箱采用交流电源供电，请确保电源与冰箱之间设有漏电断路器。
- 务必保证地面坚固和平整，并且能够支撑冰箱及存储物的重量。
- 冰箱必须安装固定在橱柜内，以便在车辆行驶时保持安全。
- 冰箱的左右两侧不需要间隙，冰箱后侧与橱柜需要最少 20mm 的间隙，以便散热通风（图 4）。
- 将冰箱牢固地推入其固定位置。打开冰箱门，将六个螺丝通过冰箱内侧的六个塑料护套，将冰箱固定在橱柜内，然后盖上塑料帽（图 5）。

6.2 连接直流电源

冰箱可工作于 12V 或 24V 直流电源，连接方式请见后附电路接线图（图 24）。

注意!

- 为避免压降和性能损失，请尽量使用较短的电线并避免交叉，因此，要避免多余的开关、插头。

建议线束长度不能超过 2m，线束直径不能小于 2mm^2 。如果线束长度超过 2m，对应的线束直径请见下表：

线束直径	最大长度 /12V	最大长度 /24V
2.5mm^2	2.5m	5m
4mm^2	4m	8m
6mm^2	6m	12m
10mm^2	10m	20m

当电压不足时（参见下表），冰箱将自动断开，以保护电池。

额定电压	12V	24V
开机电压	11.7V	24.2V
关机电压	10.4V	22.8V

6.3 连接交流电源

连接方式请见后附接线图。

- 冰箱可工作于 100-240V 交流电源（50/60Hz），若是交直流电源同时接入冰箱，冰箱电控板会优先选择交流供电，减少对蓄电池的依赖并延长电池寿命。

7.0 冰箱的使用



	电源开关
	温度设定
	运行模式设定
	压缩机故障报警灯(红色)

7.1 冰箱开机

通过触摸开关按键  开机。

- 当冰箱连接电源为交流电时，AC 灯亮起；接入直流电时，DC 灯亮起；冰箱开启，电源指示灯恒亮。
- 冰箱开启，所有工作指示灯均亮起，3 秒后，除了电源指示灯亮，其它均进入休眠模式。
- 开机后，压缩机启动有一定的延时，请您耐心等待。

7.2 温度设置

设置温度，通过触摸温度设定按键  设定。

- 触摸温度设定按键，将温度设置在从“冷”到“很冷”五个档位中的一个。
- 温度设定完毕后，指示灯进入休眠模式。

提示

制冷性能会受到以下因素的影响：

- 环境温度
- 保存的食物数量
- 门打开的频率
- 电池保护电压

7.3 运行模式设置

通过触摸 MODE 按键  设定冰箱的运行模式：

- SNOOZE：睡眠模式，在这种模式下，压缩机和风机在最低转速下运行以减少噪音。
- QUICK COOL：快速制冷模式，在这种模式下，以预设定的压缩机转速值快速制冷。

7.4 故障报警

在电源指示灯区域，有一个红色故障指示灯 

- 如果冰箱运行出现故障，红色指示灯会闪烁，闪烁的次数取决于故障类型。
- 每四秒闪烁 1 至 5 次后会有一个停顿，闪烁次数及对应的故障类型如下：

闪烁次数	故障	可能原因
1	电池保护停机	供电电压超出设定范围
2	风机过电流	风机负载电路中的电流超过设定 1A
3	电机不启动	压缩机转子堵塞，制冷系统中的压差太大 (> 5bar)
4	压缩机最小转速	制冷系统负载太大
5	压缩机电控板过热	控制器内部过热，可能由于环温过高，负载太大
常亮	温探头问题	检查温控线束连接

7.5 搁物架取出

如需取出搁物架，请按照如下步骤操作：

- 打开冰箱门，开至 90°或者大于 90°。
- 抬起搁物架后端（见图 07）。
- 向前拉动搁物架，直至取出即可。

06



07



7.6 左右开门更换

如需更改开门方向，请按照如下步骤操作：

- 打开冰箱门，开至 90° 或者大于 90°。
- 使用 “—” 字螺丝刀下压 ① 处，取下上铰链轴（注意里面有弹簧）。
- 向上提冷冻室门体，脱离中铰链轴，取下门体。
- 使用 “+” 字螺丝刀卸下门体上的把手和另外一侧的装饰盒盖。
- 使用 “—” 字螺丝刀取下中铰链轴 ②。
- 向上提冷藏室门体，脱离下铰链轴，取下门体。
- 使用 “+” 字螺丝刀卸下门体上的把手和另外一侧的装饰盒盖。
- 将冷冻门体和冷藏门体取下的把手和装饰盒盖，分别对调安装在翻转后冷藏门体和冷冻门体上。
- 取下挂盒，重新反转安装在门体上。
- 使用 “+” 字螺丝刀卸下把手挡块，安装到另外一侧。
- 使用 “+” 字螺丝刀卸下中间铰链，将其翻转 180° 安装到另外一侧。
- 使用 “—” 字螺丝刀取下下铰链轴 ③，安装到另外一侧。
- 将冷藏室门体插入下铰链轴内，使用 “—” 字螺丝刀将中铰链轴安装到中铰链上，冷藏箱门体安装完成。
- 将冷冻箱门体插入中铰链轴内，使用 “—” 字螺丝刀将上铰链轴和弹簧从压入门体，一起推入上铰链内，冷冻箱门体安装完成。
- 检查门体四周是否有缝隙，如有，用干发器加热，直至消除缝隙。

08



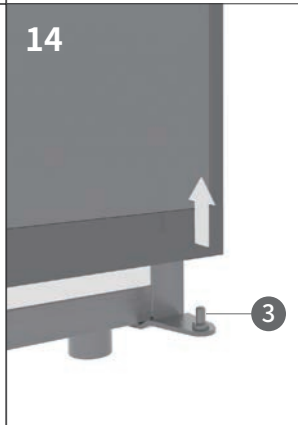
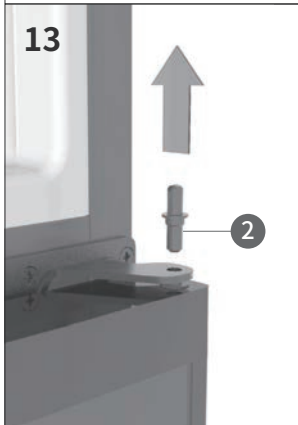
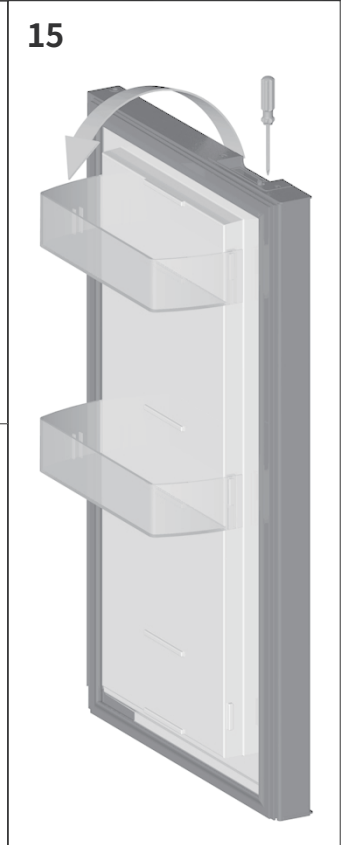
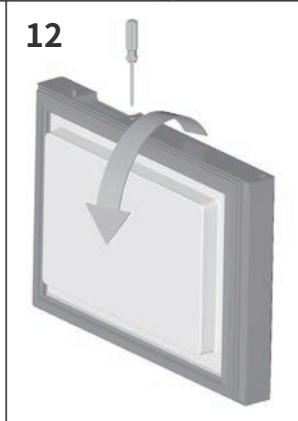
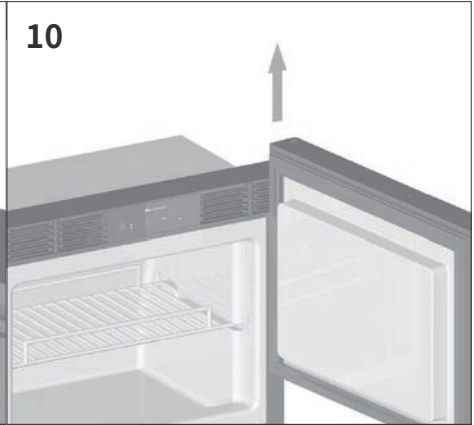
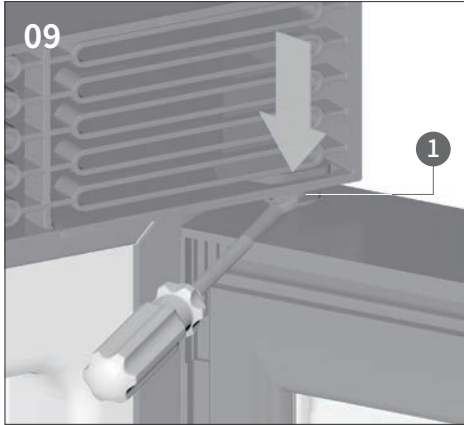

CN

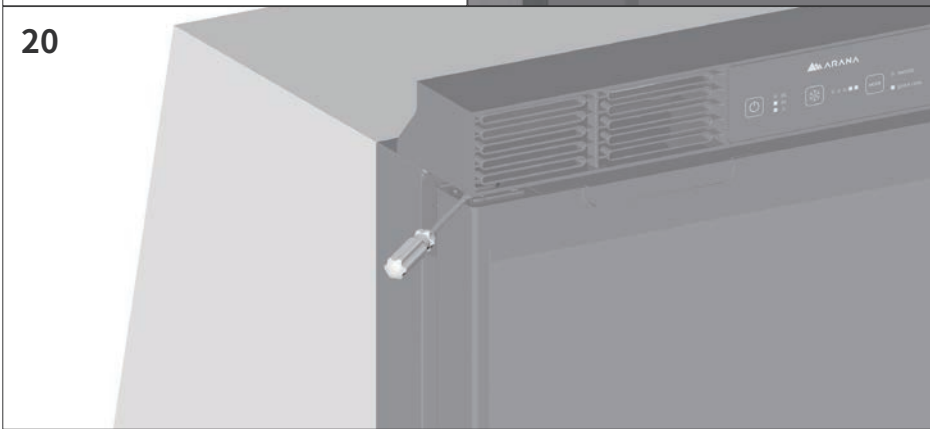
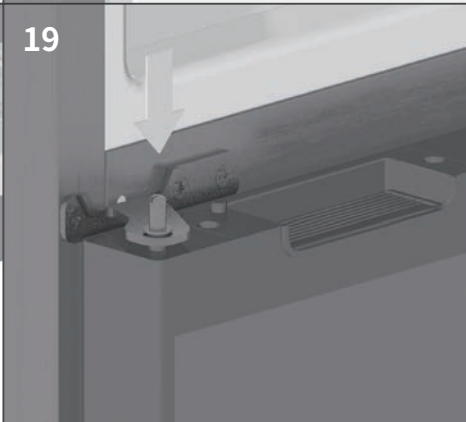
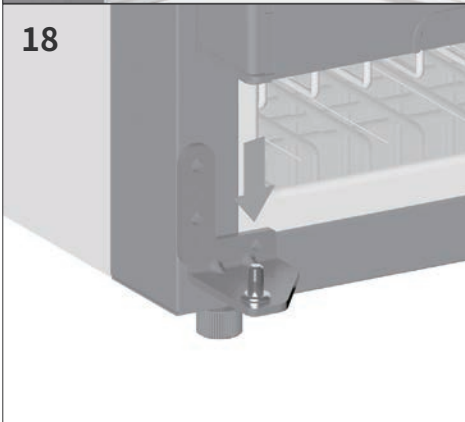
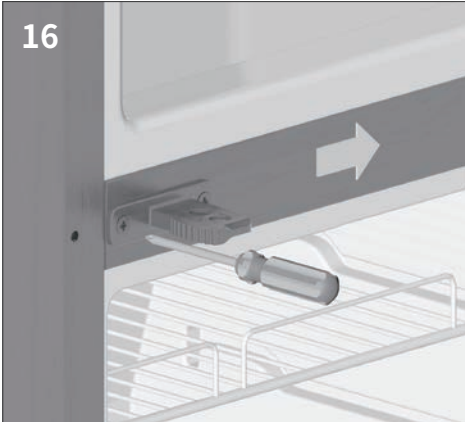

7.7 关机和存放

- 按开 / 关机键直至冰箱关机。
- 断开电源总开关。
- 清洗冰箱（参见“清洁和保养”章节）。
- 关上冰箱门，把门体固定至透气锁上，操作步骤如下：
 - a. 首先将透气锁滑块向内推动和门体导柱孔吻合，如下图所示。
 - b. 然后把冷冻室和冷藏室门把手的锁轴插入挡块外侧孔内。
 - c. 冷冻室和冷藏室门留有一定的缝隙，防止冰箱内产生霉变气味。

21

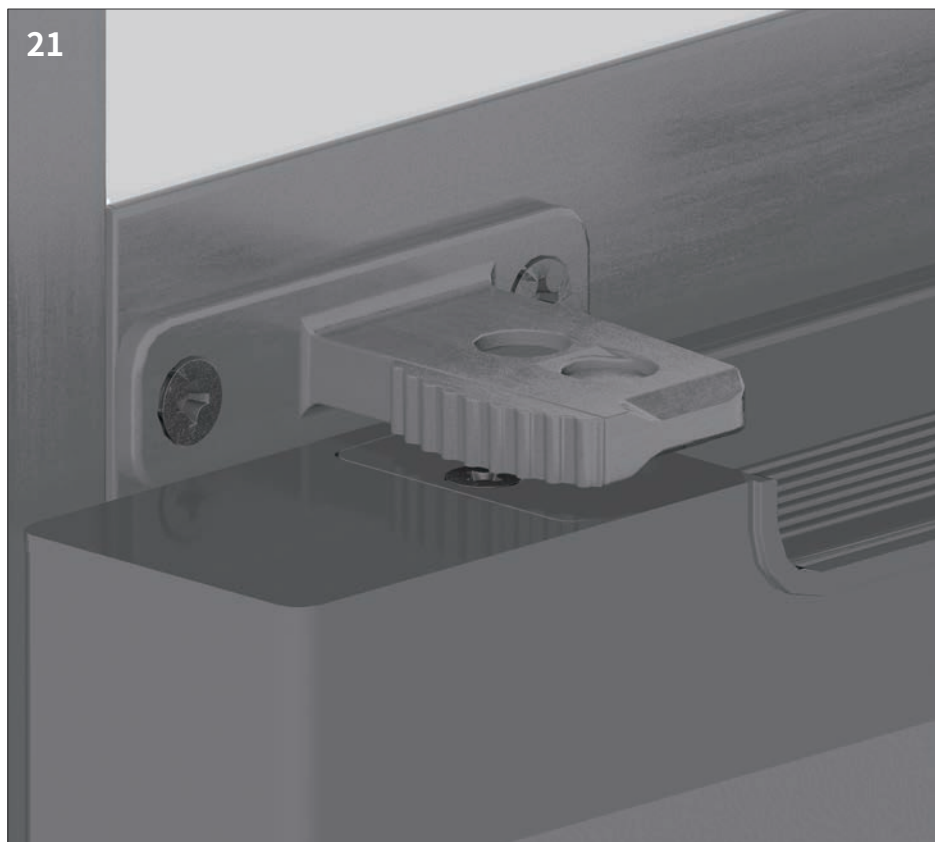

22

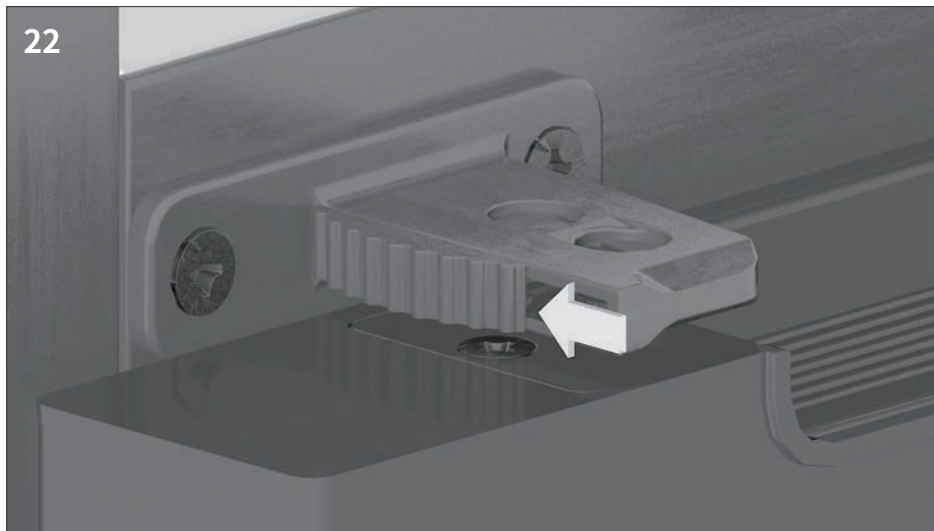

23

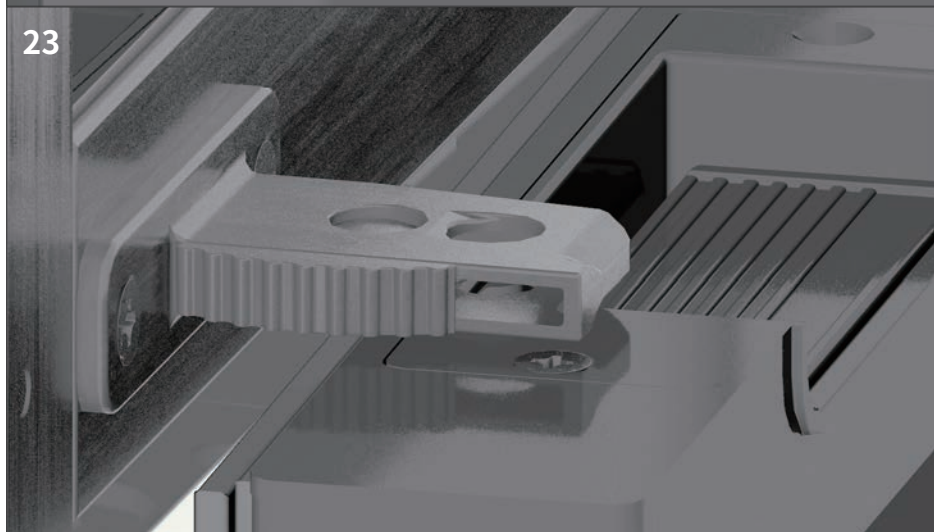
**i 提示!**

- 当冰箱闲置时，必须保证箱体内部干燥以防止细菌滋生，尽可能保持冰箱门处于打开状态。

8.0 清洁和保养

危险!

- 为避免电击，请在清洗冰箱前切断电源。忽视本警告可能导致人身伤害。

注意!

- 不要使用研磨性质的清洁剂或硬物来清洁冰箱以免损坏冰箱。
- 不要使用硬质或锐利的工具清除冰箱上的冰层或是冻结后的物体。
- 取出箱体内部存放的东西。
- 用湿布擦洗箱体内外部。
- 清洗后，用干布擦干冰箱。

9.0 技术参数

	BFC 96	BFC 96/96DC
冰箱总容积		96L
冷冻室容积		20L
电压	100V ~ 240V	12V/24V
功耗（白天 / 夜间）模式		0.46/0.36kWh/24h
额定电流	0.25A	4.5A/2.5A
冷藏温度		0° C 至 10° C
冷冻温度		-10° C 至 -18° C
气候类型		N(4)
噪声 白天 / 夜间模式		33/28dB(A)
尺寸		419×472×1098mm
重量		23Kg
发泡剂		C5H10
测试 / 认证		CE

i 提示

- 我们将不断改进我们的产品，并保留修改某些规格的权利，恕不另行通知，请以产品铭牌为主。

10.0 故障排除

(1) 压缩机不工作（连接交流电时）

问 题	原因分析	采取措施
没有电压	电源线断开	重新连接
	主开关故障（如果已安装）	更换主开关
	环境温度过高	-
有电压但是 压缩机不工作	通风不足	清理现有通风设施或者 安装更有效的通风设施
	冷凝器有脏污	清洗冷凝器
压缩机内电路针脚断开	压缩机不良	更换压缩机

(2) 冷却效果差，内部温度升高

问 题	原因分析	采取措施
压缩机工作 很长时间 或是一直 处于工作状态	环境温度过高	-
	通风不足	升级以满足安装指南中的 要求
	风扇故障	更换风扇
压缩机间歇工作	电池电量耗尽	给电池充电

(3) 压缩机异常噪音

问 题	原因分析	采取措施
很大的嗡嗡声	制冷系统的某个零件不能自由 移动（靠近墙壁）	将该零件小心移开
	杂物卡在制冷系统和墙壁之间	清除杂物
	风扇噪音	更换风机

11.0 零部件明细表

25

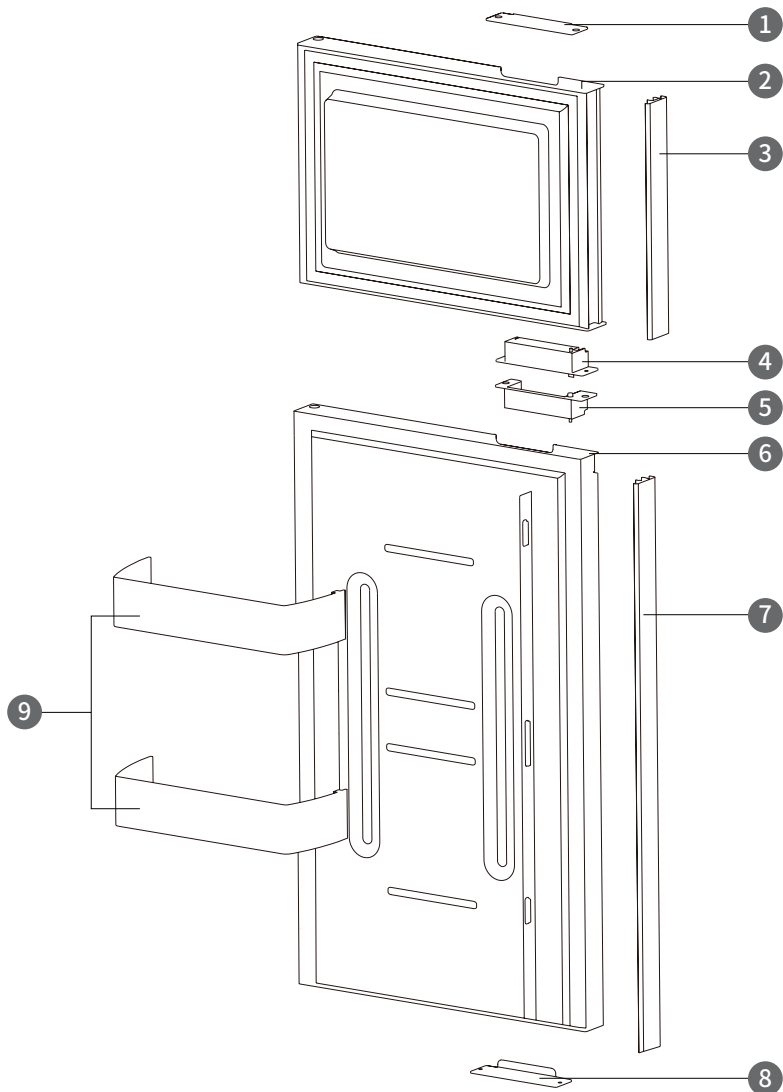

26

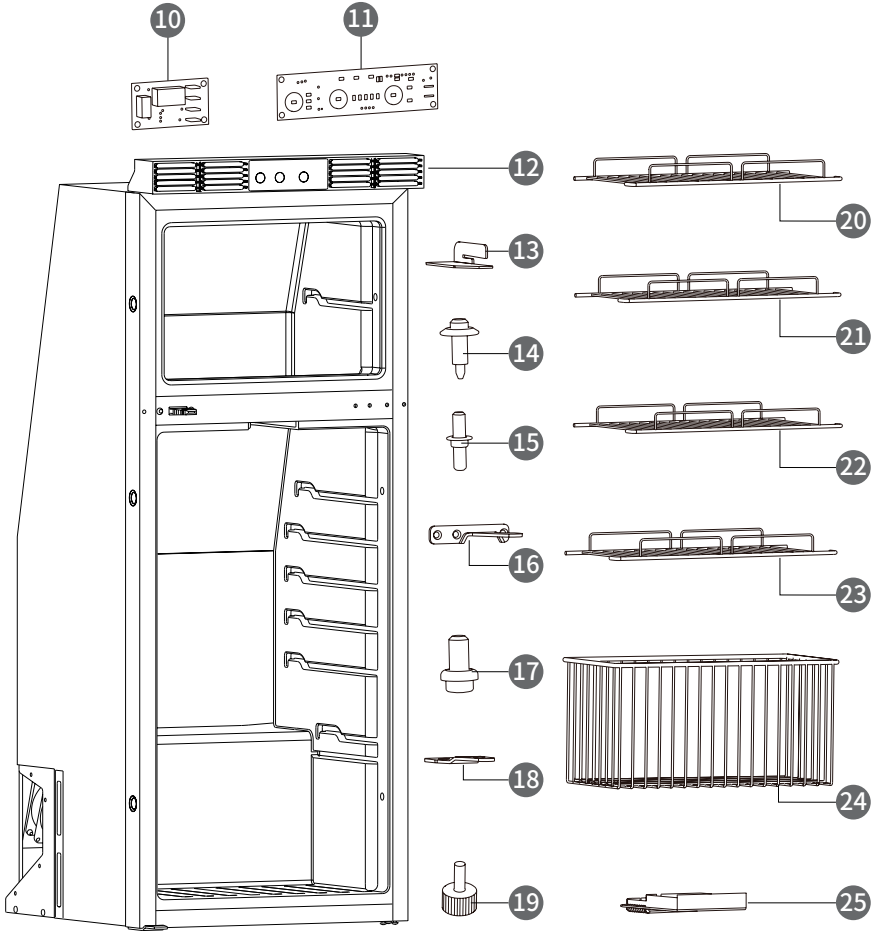

27

CN

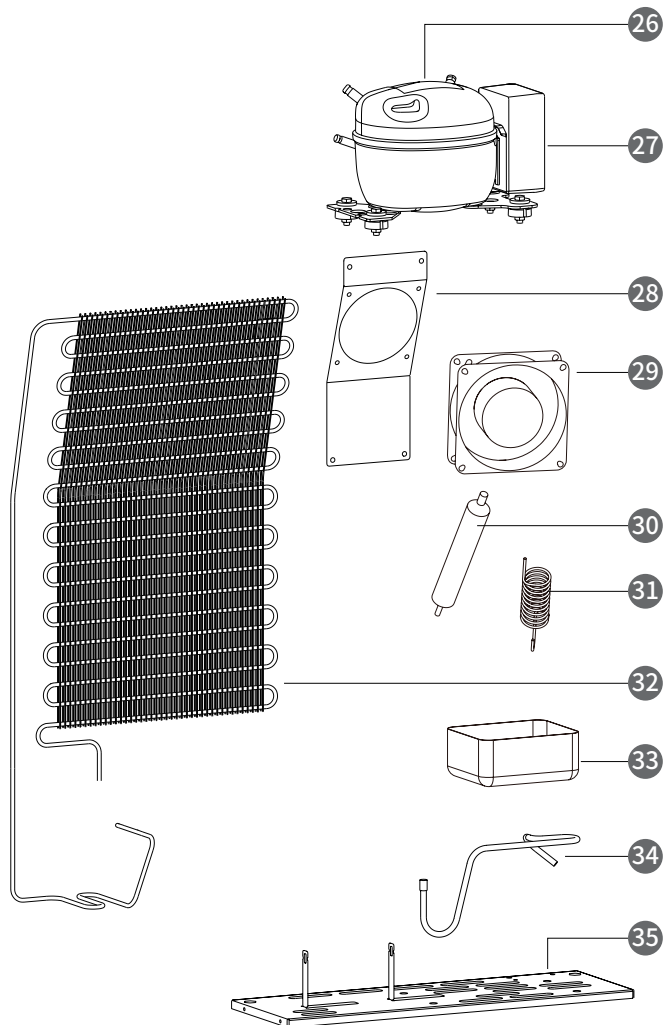

序号	名称	物料号	数量
1	上装饰板盒盖	01.03.09040009	1
2	冷冻室门体	01.03.09040060	1
3	冷冻室左边框	01.03.09040019	1
4	冷冻室把手盒总成	01.03.09040061	1
5	冷藏室把手盒总成	01.03.09040063	1
6	冷藏室门体	01.03.09040062	1
7	冷藏室左边框	01.01.09040045	1
8	下装饰板盒盖	01.03.09040009	1
9	大挂盒	DL05001295	2
10	电路板	01.02.09040058	1
11	控制板	01.02.09040059	1
12	面罩总成	01.03.09040064	1
13	右上铰链	01.01.09040119	1
14	上铰链轴	01.01.09040049	1
15	中铰链轴	01.01.09040050	1
16	中铰链	01.01.09040122	1
17	下铰链轴	01.01.14540130	1
18	右下铰链	01.01.14540134	1
19	底脚	DL02501219	4
20	冷冻搁物架	01.01.09040092	1
21	冷藏上搁物架	01.01.09040081	1
22	冷藏中搁物架	01.01.09040093	1
23	冷藏下搁物架	01.01.09040094	1
24	果蔬筐	01.01.09040095	1

序号	名称	物料号	数量
25	灯盒总成	01.03.09040065	1
26	压缩机	01.02.00040217	1
27	压缩机启动器	01.02.00040217	1
28	风机支架	01.01.09040116	1
29	风机	DL22502297	1
30	干燥过滤器	01.04.04040006	1
31	毛细管	01.08.00050024	1
32	冷凝器	01.04.09040003	1
33	接水盒	DL10001155	1
34	回气管	01.04.09040005	1
35	机组板	01.01.09040115	1

12.0 质量保证

该产品适用法律规定的保修条款和条件，如果产品出现故障，请与最近的经销商联系。

维修该冰箱，请准备好如下文件：

- 注明购买日期的发票复印件。
- 故障的描述或索赔原因。

但是产品的保修将不覆盖如下情况：

- 在消费者使用产品时所发生的损坏、事故等，而这些损坏不是由于产品材料的缺陷或制造原因导致的。
- 消费者未按照说明书规定进行的误操作而导致的损坏。
- 整机外观破损，包括磨损导致的外观损坏。
- 未经制造商授权的维修、更改。



保修卡

客户姓名		联系电话	
产品名称		产品型号	
购买日期		序列号	
如果该设备为车厂原装冰箱,请您填写如下车辆信息:			
车辆品牌		车辆型号	
购买日期		车架号	
<p>本保修卡请用户妥善保管,以做维修凭证。 保修期限自购买之日起十二个月内。 全国统一服务电话: 400 110 1890</p>			 请关注微信公众号







阿雷纳科技(深圳)有限公司
 ARANA Technology (Shenzhen) Co., Ltd.

Thanks for choosing **ARANA** refrigeration device. Please read the instructions carefully before installation or first use of the refrigerator and store it in a place where all users could find it for easy reference. If the refrigerator is transferred or sold, please hand over the instructions along with it so that the new user is aware of installation methods, usage and safety requirements.

Table of content

1.0 Explanation of symbols	33
2.0 Safety instructions	33
2.1 General safety instructions.....	34
2.2 Safe operation instructions.....	34
3.0 Intended use	35
4.0 Technical description	36
5.0 Installing the door panel	36
6.0 Installation and connection	38
6.1 Installing the refrigerator.....	42
6.2 Connecting the refrigerator to DC power supply.....	42
6.3 Connecting the refrigerator to AC mains.....	43
7.0 Using the refrigerator	44
7.1 Switching on the refrigerator.....	44
7.2 Temperature setting.....	45
7.3 Operation mode setting.....	45
7.4 Fault alarm.....	45
7.5 Removing the shelves.....	46
7.6 Reversing the doors.....	48
7.7 Switching off and storing.....	51
8.0 Cleaning and maintenance	52
9.0 Technical data	54
10.0 Troubleshooting	55
11.0 Spare parts list	57
12.0 Warranty	62

1.0 Explanation of symbols

-  **DANGER!** Failure to observe this instruction can cause fatal or serious injury.
-  **WARNING!** Failure to observe this instruction can lead to minor or moderate injury.
-  **CAUTION!** Failure to observe this instruction can cause material damage and impair the function of the product.
-  **NOTE** Supplementary information for operating product.

2.0 Safety instructions

- Only use the refrigerator for purposes described in the instructions.
- The refrigerator must be installed correctly under the guidance of the instructions before using.
- If the power cable of the device is damaged, it must be repaired and replaced by qualified technician immediately. Any cable, plug or connecting point with crack and abrasion must not be used to avoid potential safety hazard.
- The refrigerator must be powered down during cleaning or repairing.
- Never use the refrigerator in an environment where flammable gases are present.
- AC power must be reliably grounded.
- Do not use modified plug or self-prolonged cable.

-  **CAUTION!**
Do not open the refrigerant circuit under any circumstances. A qualified technician is recommended for any repair.

ARANA accepts no liability for damage in the following cases:

- Faulty assembly or connection.
- Damage to the product resulting from mechanical influences and overvoltage.

- Alterations to the product without expressing permission from the manufacturer.
- Use for purposes other than those described in the instructions.

2.1 General safety instructions

EN

WARNING!

- The device must be repaired by qualified technician.
- Inadequate repairs may cause more serious hazards.
- Do not operate the device if it is visibly damaged.
- This device can be used by children aged 12 or over, as well as persons with diminished physical, sensory or mental capacities or a lack of experience and knowledge, providing they are supervised, or have been taught how to use the device safely and are aware of the resulting risks.
- Operating, cleaning and user maintenance must not be carried out by children without supervision.
- Danger of crushing! Do not put your fingers into the hinge.
- Foodstuff may only be stored in its original packaging or in suitable containers.

CAUTION !

- Check the voltage specification on the data plate to make sure it is the same as the power supply.
- The refrigerator is not suitable for storing substances which are caustic or contain solvents.
- Please disconnect the DC power supply if you do not intend to use the refrigerator for an extended period of time when it is installed in caravans, motorhomes and on boats.

2.2 Safe operation instructions

**DANGER!**

- Do not touch exposed cables with your bare hands, especially when the refrigerator is in operation with AC power.

**CAUTION !**

- Before starting the device, making sure the power line and the plug are dry.
- Do not place the refrigerator near naked flames or other heat sources (heater, direct sunlight and gas over etc.)
- **DANGER OF OVERHEATING!** Always keep sufficient ventilation so that the heat generated during operation can dissipate.
- Ensure the **ventilation grille** on the top of the refrigerator is not blocked or covered.
- Protect the device and cables against heat and moisture.
- Ensure foodstuffs do not touch the inwall of cooling area.

EN

3.0 Intended use

- The refrigerator is suitable for installation in caravans, motorhomes, boats and also homes.
- The refrigerator is only suitable for installation in a fitted cavity. Once it is installed, only the front of the device is accessible.
- The refrigerator is only suitable for refrigerating, freezing and storing food, but not for medicine storage.

**WARNING!**

- Please check if the refrigeration capacity of the refrigerator is suitable for storing the food you wish to cool.

4.0 Technical description

- The upper is freezer compartment, the lower is refrigerator compartment.
- The device is designed to be operated with 12 V DC or 24 V DC on-board supply as well as 100 – 240 V AC mains.
- All materials used in the refrigerator are compatible for use with foodstuffs. The refrigerant circuit is hermetically sealed and CFC-free.
- The refrigerator can withstand a short term inclination of 30° , for example on boats.
- The temperature of refrigerator compartment can be adjusted by control panel.



CAUTION!

Make sure the correct connection to the power supply.

- Before starting up the device for the first time, checking whether the operating voltage matches the battery voltage (see data plate).
- When connecting to DC power supply, the circuit shall be protected by fuses with maximum 15A (12V) or 7.5A (24V).
- When connecting to AC power supply, the circuit shall be protected by fuses with maximum 4A (220V).
- When connecting to DC power supply: The red cable of the DC power supply connects to the positive pole of the battery and the white cable connects to the negative pole of the battery.
- When connecting to AC power supply: The socket must be properly grounded and fuse protected.

5.0 Installing the door panel

- Installing the door panel is preliminary before the refrigerator installation.
- The thickness of door panel must be less than or equal to 4mm .
- Dimension of the upper door panel: 408mm (width) x 242mm (height);
Dimension of the lower door panel: 408mm (width) x 655mm (height).

01

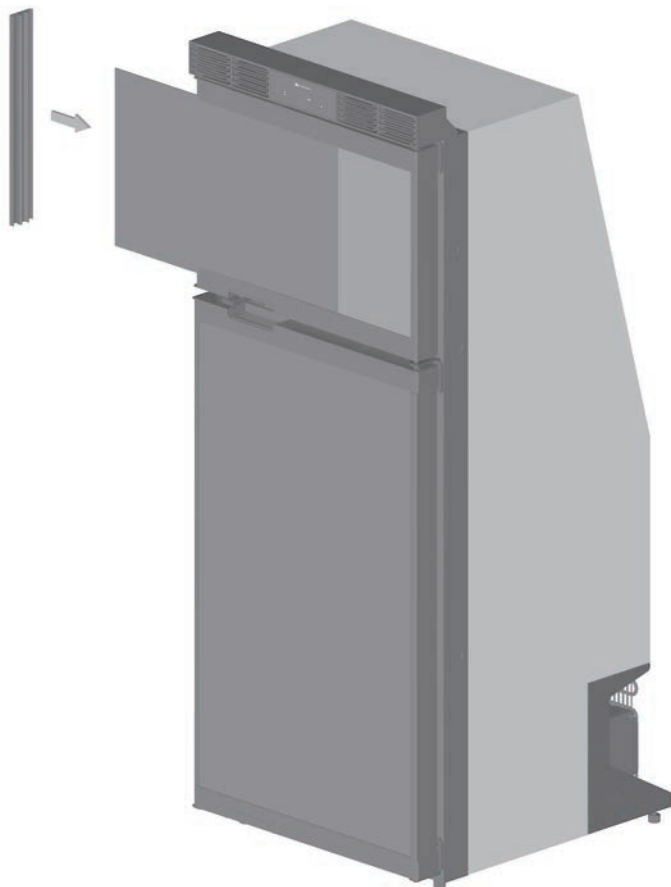

EN

6.0 Installation and connection

02

EN

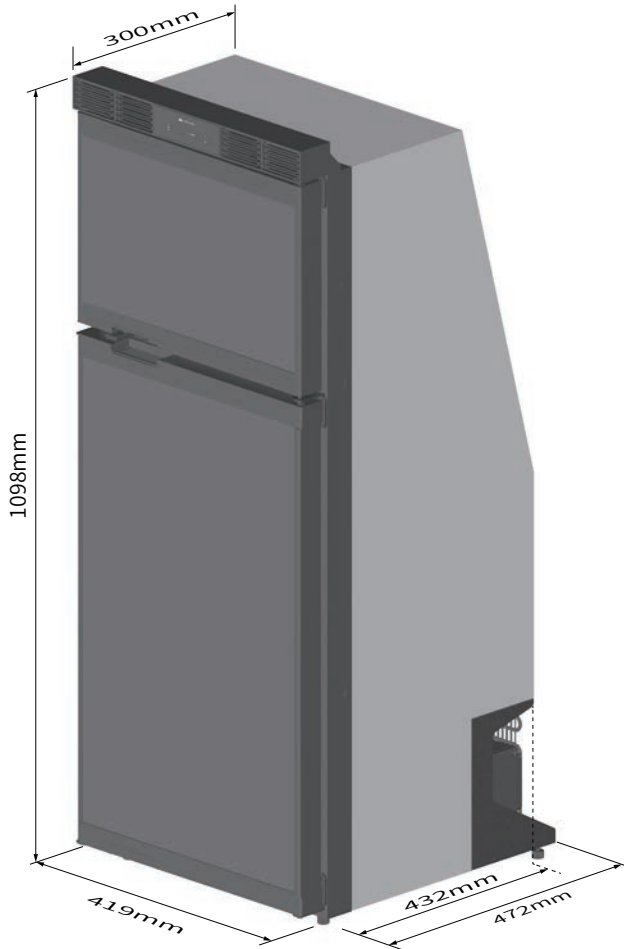

03

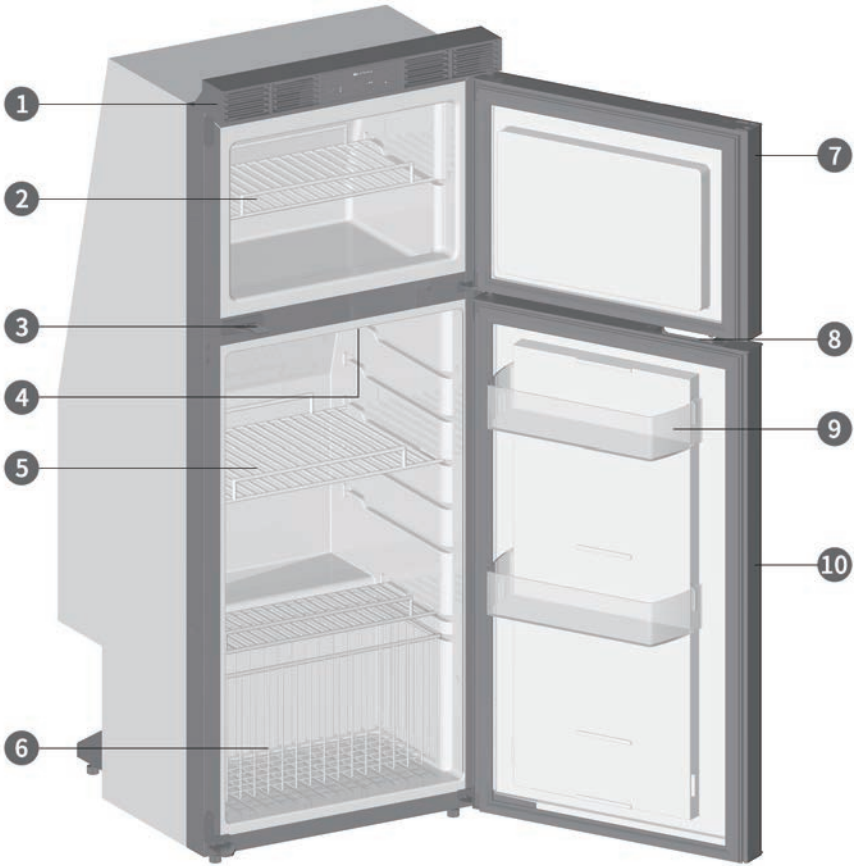

1	Ventilation grille	6	Fruit and vegetable section
2	Freezer shelf	7	Freezer door
3	Locking catch	8	Handle
4	Built-in lamp	9	Door bin
5	Refrigerator shelf	10	Refrigerator door

04

EN

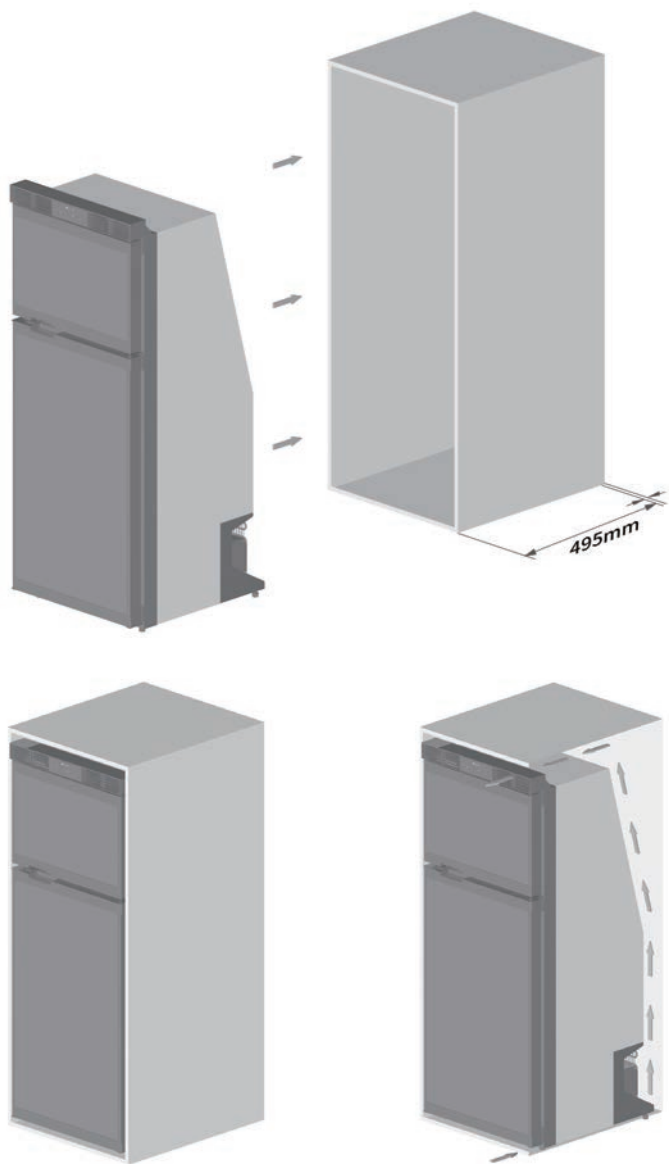

05

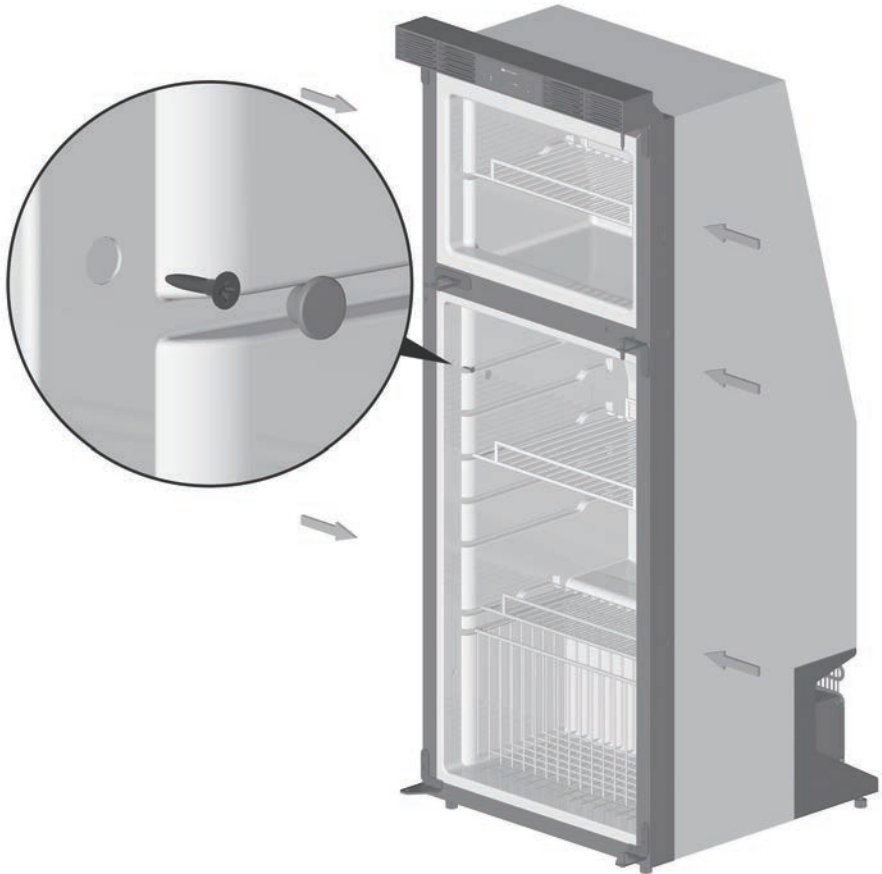

EN

6.1 Installing the refrigerator

When installing the refrigerator, note the following:

DANGER!

- When connected to the AC mains, a residual current circuit breaker must be installed between the refrigerator and the AC mains.
- Ensure that the floor is solid and level, must be able to support the weight of the refrigerator and contents.
- The refrigerator must be installed in a recess so that it stands secure when the vehicle is in motion.
- No clearance is required on both sides of the refrigerator, but a minimum of 20mm clearance is required between the back of the refrigerator and the cabinets to dissipate heat and ventilation. See FIG.04.
- Push the refrigerator firmly into its final location, open the refrigerator doors, push the six screws through the six plastic bushes on the insides of the refrigerator, fasten into the recess walls, and then cover the plastic caps. See FIG.05.

6.2 Connecting the refrigerator to DC power supply

The refrigerator can be operated with a 12V DC or 24V DC voltage supply, please see the attached circuit wiring diagram. See FIG.24.

CAUTION!

- To avoid voltage drops and loss of performance, keep the connection cable as short as possible and uninterrupted. Therefore, avoid additional switches and plugs.

It is recommended that the cable length should not exceed 2 meters and the cross section of the cable should not be less than 2mm². Please check the following cross section if the cable exceeds 2 meters long.

The cable cross section	Maximum length/12V	Maximum length/24V
2.5mm ²	2.5m	5m
4mm ²	4m	8m
6mm ²	6m	12m
10mm ²	10m	20m

To protect the battery, the refrigerator switches off automatically if the voltage is insufficient (see below table).

Rated voltage	12V	24V
Cut-in voltage	11.7V	24.2V
Cut-off voltage	10.4V	22.8V

6.3 Connecting the refrigerator to AC mains

Please refer to the attached wiring diagram for the connection method.

- The refrigerator can be operated with 100~240V AC voltage. If the refrigerator is connected to DC and AC power supply at the same time, the refrigerator electronic unit will give priority to AC mains, to reduce the dependence on the battery and extend battery life.

7.0 Using the refrigerator

EN



Power switch



Temperature setting



Operation mode setting



Compressor error light

7.1 Switching on the refrigerator

Start the device by touching the switch button

- When the refrigerator is connected to AC power supply, the AC indicator lamp will light up. Connecting to the DC power supply, the DC indicator lamp will light up. Once started, the power light will always be on.
- After the refrigerator is switched on, all indicator lamps will light up. And all indicator lamps will be off after 3 seconds except the power light.
- Please wait for a moment as the compressor will start up with some delay after the refrigerator is switched on.

7.2 Temperature setting

Setting the temperature by touching the temperature setting button 

- Touching temperature setting button to set the temperature from "cold" to "very cold".
- After finishing the temperature setting, the indicator lamp will be off.



NOTE

The cooling performance can be affected by:

- The ambient temperature
- The amount of food to be conserved
- How often you open the door
- Battery low voltage protection

7.3 Operation mode setting

Setting the operation mode by touching the MODE button 

- SNOOZE: The fan operates at low speed and the compressor speed is limited, to reduce noise.
- QUICK COOL: The compressor operates in preset high speed and the refrigerator gets rapid cooling.

7.4 Fault alarm

Below the power supply lights, there is an error indicator lamp 

- The error light flashes red if there is an issue. The number of flashes indicates the type of error that has occurred.
- The error light flashes 1 to 5 times every 4 seconds followed by a short rest period. The different flash times indicate the following possible issues:

Flicking times	Fault	Possible cause
1	Battery protection cut-out	Low voltage issue
2	Fan over cut-out	The current overload on the fan in excess of 1.0 Amps
3	Motor start error	The rotor may be blocked or the differential pressure in the refrigerant circuit is too high (>5bar)
4	Minimum motor speed error	Too much load on the refrigerant circuit
5	Thermal cut-out of electronic unit	The electronic module is too hot due to the high ambient temperature or overload
LED Lit continuously	Thermostat error	Checking the connection of temperature control cable

7.5 Removing the shelves

Remove the shelves as the following steps when needed.

- Open the doors to 90° or more.
- Tilt the back end of the shelf up. See FIG.07.
- Remove the shelf by pulling it forward.

06



EN

07



7.6 Reversing the doors

Reverse the doors as the following steps when needed:

- Open the doors to 90° or more.
- Press down **1** with a flat screwdriver, and pull out the upper hinge pin (note there is a spring below) .
- Remove the freezer door by lifting it up until it clears the center hinge pin.
- Remove the handle components and handle blanks from the opposite side of the freezer door with a cross screwdriver.
Remove the center hinge pin **2** with a flat screwdriver.
- Remove the refrigerator door by lifting it up until it clears the lower hinge pin.
- Remove the handle components and handle blanks from the opposite side of the refrigerator doors with a cross screwdriver.
- Install the removed handle components and handle blanks on the overturned freezer and refrigerator doors respectively.
- Remove the door bins, reverse and install them on the refrigerator door.
- Remove the locking catch with a cross screwdriver and install it on the opposite side.
- Remove the center hinge with a cross screwdriver, rotate it 180 degrees, and install it on the opposite side.
- Remove the lower hinge pin **3** with a flat screwdriver and install it on the opposite side.
- Position the refrigerator door on the lower hinge pin, and install the center hinge pin into the center hinge with a flat screwdriver. The refrigerator door is fixed now.
- Position the freezer door on the center hinge pin, press the upper hinge pin and spring into the door, and push them together into the upper hinge. The freezer door is fixed now.
- Check whether there are gaps between the doors and body, if so, heat it with a dryer until the gaps are removed.

08

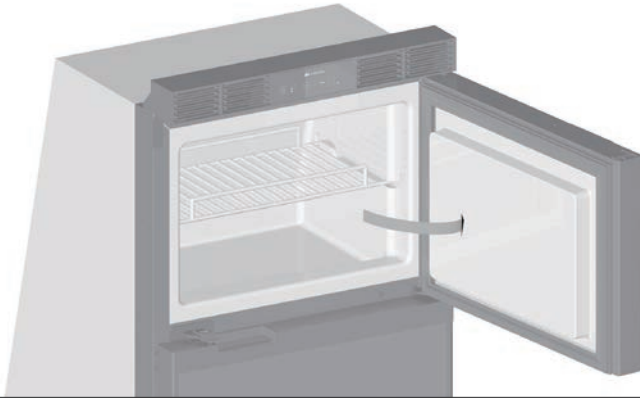

09

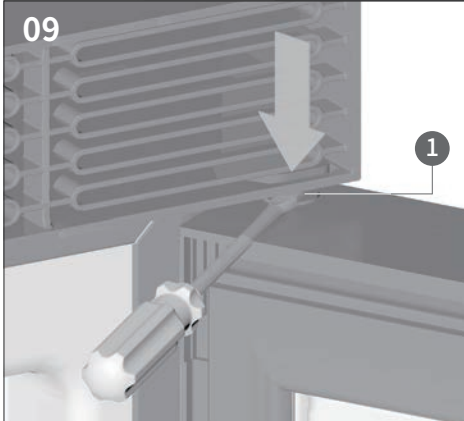

10

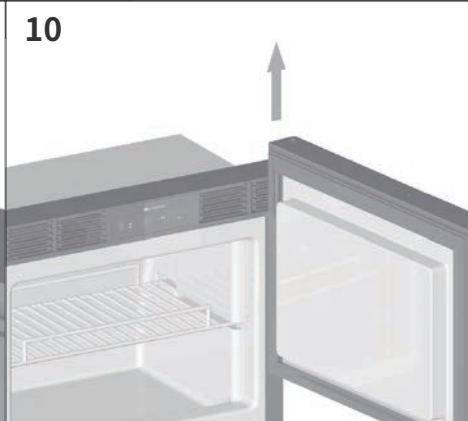

11



12



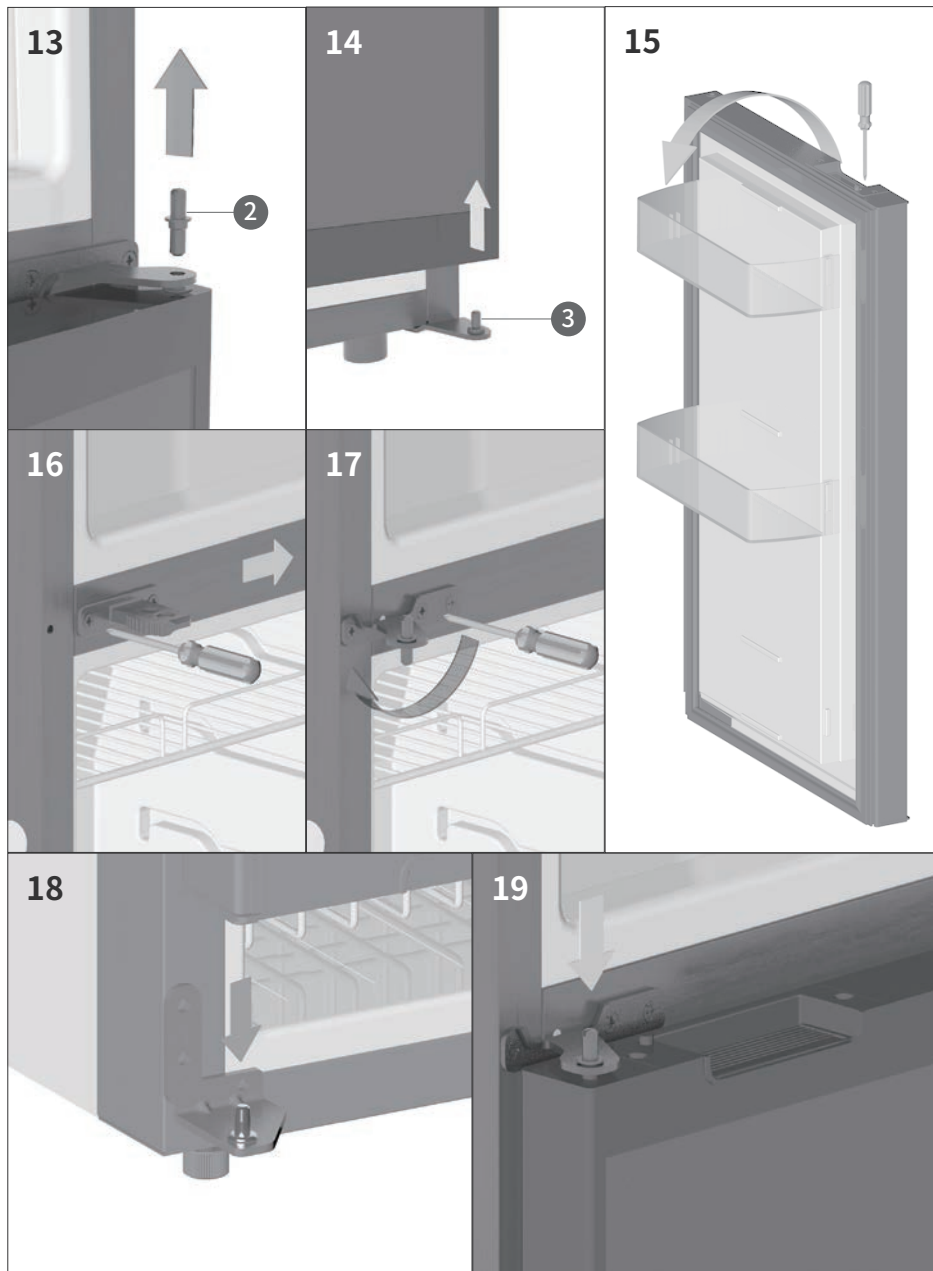

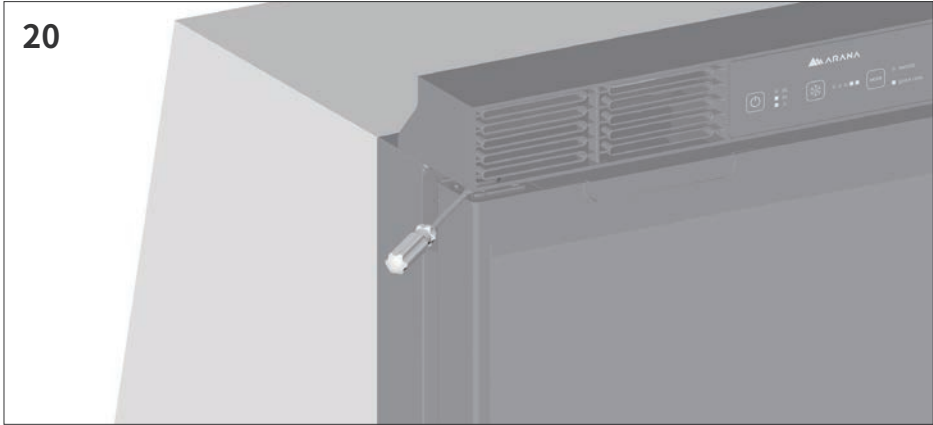

7.7 Switching off and storing

- Press and hold the power switch until the light is off.
- Disconnect the main power supply.
- Clean the refrigerator (see 7.0 Cleaning and Maintenance).
- Open the refrigerator doors and hold them to the airing lock as the following steps:
 - a. Push the lock slider inward.
 - b. Insert the handle pins to the outside hole of the locking catch.
 - c. Latch the doors slightly opened to prevent mould from forming.



22

EN

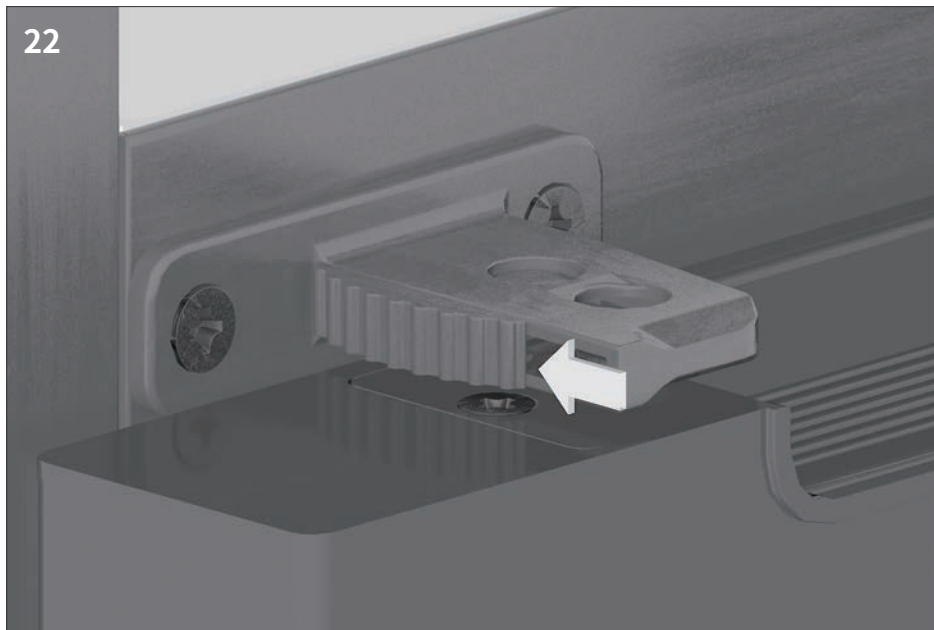

23

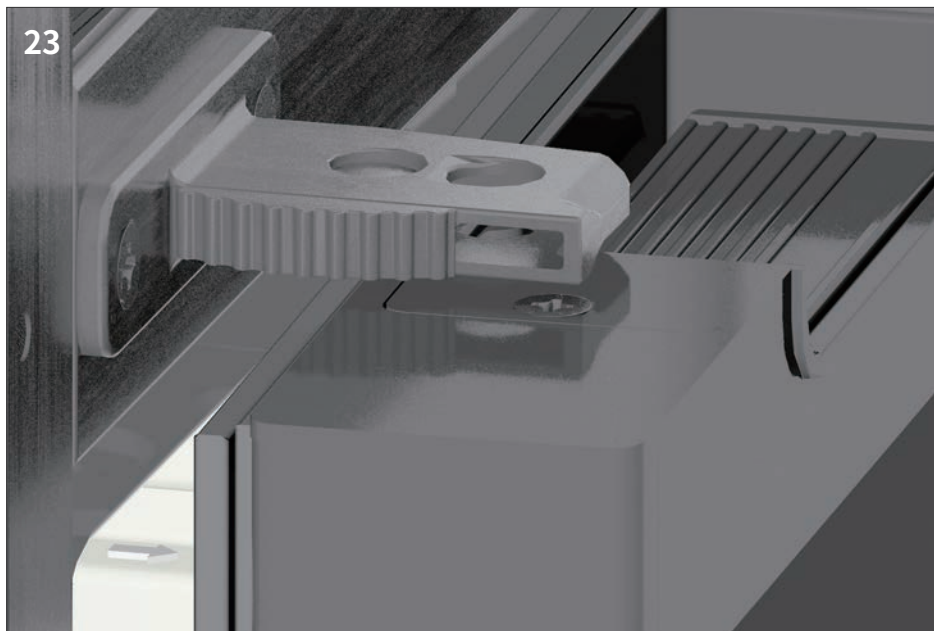

**NOTE**

- When the refrigerator is idle, keep inside being dry for preventing the growth of bacterial.

8.0 Cleaning and maintenance

**DANGER!**

- Always disconnect the refrigerator from the mains before you clean and service it.

**CAUTION!**

- Do not use abrasive cleaning agents or hard objects during cleaning as these can damage the refrigerator.
- Do not use hard or sharp tools to remove ice or free objects frozen in the device.
- Take the stored stuff out of the refrigerator.
- Clean the refrigerator with a damp cloth.
- Wipe the refrigerator dry with a cloth after cleaning.

9.0 Technical data

	BFC 96	BFC 96/96DC
Gross volume		96L
Freezer storage volume		20L
Connection voltage	110V/220V	12V/24V
Power rating Day/Night Mode		0.46/0.36kWh/24h
Rated current	0.6A/0.3A	4.5A/2.5A
Refrigerating temperature range		From 0° C to 10° C
Freezer temperature range		From -10° C to -18° C
Climatic class		N(4)
Noise emission Day/Night Mode		33/28dB(A)
Dimension		419×472×1098mm
Weight		23Kg
Foaming agent		C5H10
Inspection/certification		CE



NOTE

- To continuously improve our products, we reserve the rights to change some specifications without further notice, please check the refrigerator data plate.

10.0 Troubleshooting

(1) The compressor is not running (connected to AC supply) .

Fault	Possible cause	Remedy
Device does not function and has no power	Connection supply line interrupted	Establish a connection
	Main switch faulty (if installed)	Replace the main switch
Voltage is being applied, but the compressor does not operate	Ambient temperature too high	-
	Insufficient ventilation	Clean existing ventilation or install sufficient ventilation
	Condenser is dirty	Clean the condenser
Electric circuit between the pins in the compressor interrupted	Defective compressor	Replace compressor

(2) Poor cooling, increase in interior temperature.

Fault	Possible cause	Remedy
Compressor runs for a long time/ continuously	Ambient temperature too high	-
	Insufficient ventilation	Upgrade to satisfy requirements in installation guideline.
	Fan defective	Replace the fan
Compressor does not run often	Battery capacity exhausted	Change the battery

(3) Unusual noises.

Fault	Possible cause	Remedy
Loud humming	A component of the refrigerant circuit cannot be moved freely (touching the wall)	Bend the component carefully away from the obstruction
	Some foreign objects stuck between the refrigerant circuit and the wall	Remove the foreign object
	Fan noise	Replace the fan

11.0 Spare parts list

EN

25

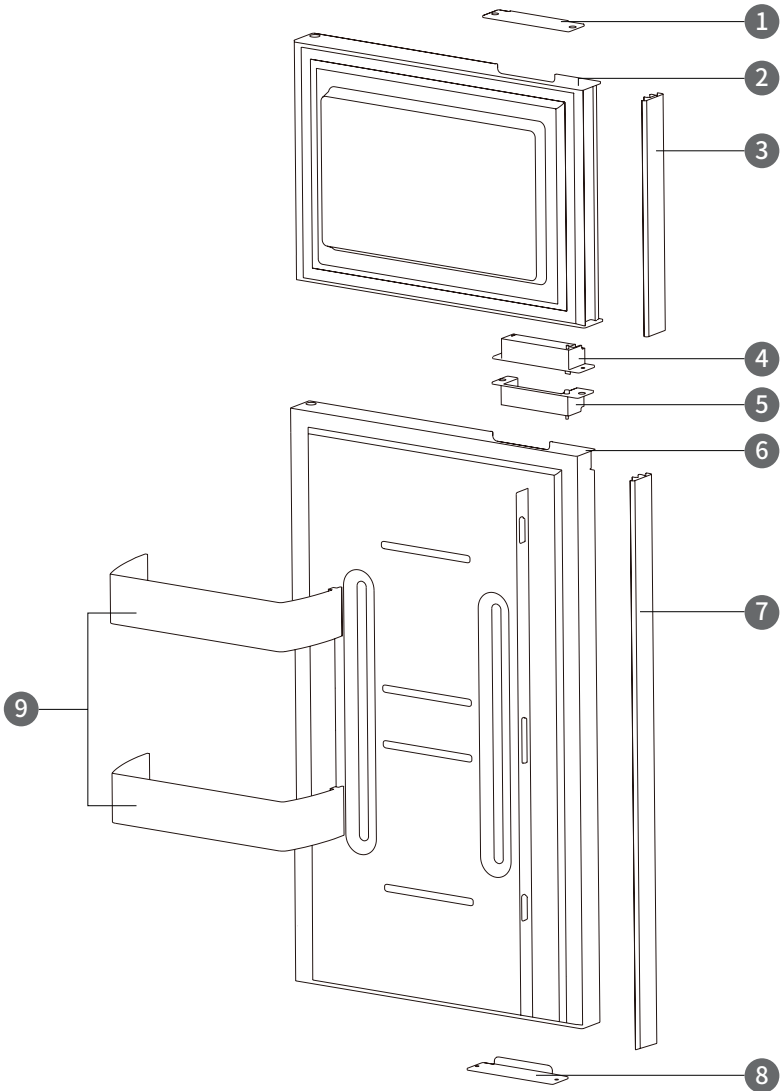

26

EN

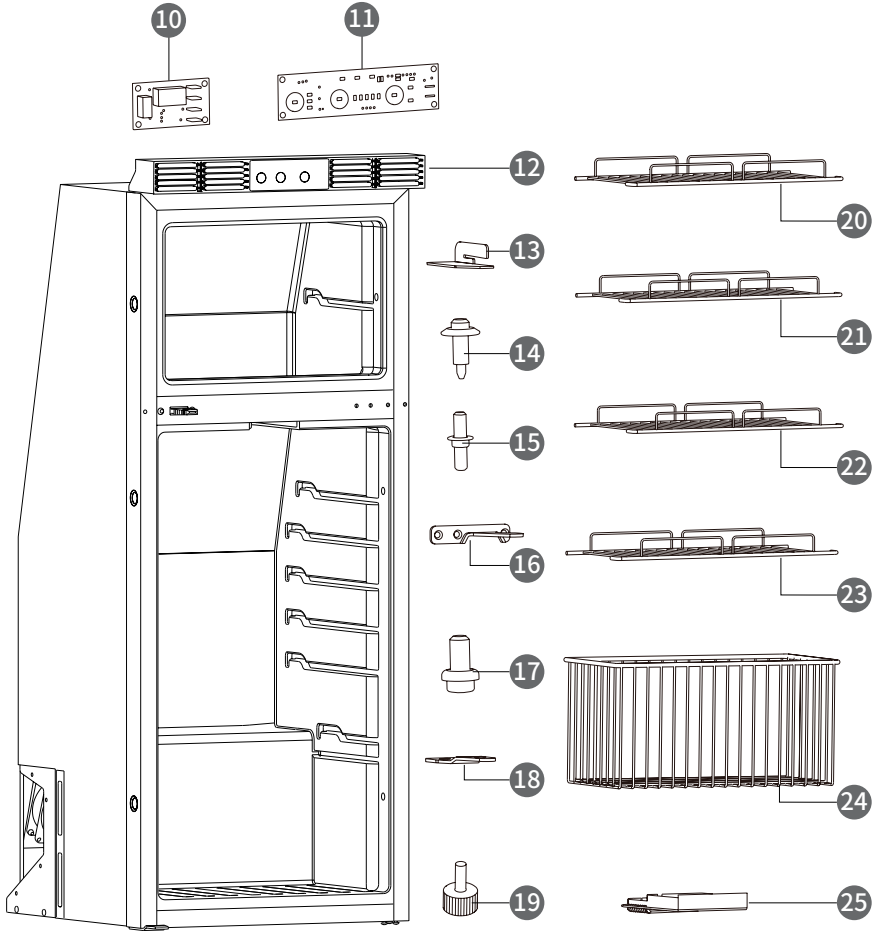

27

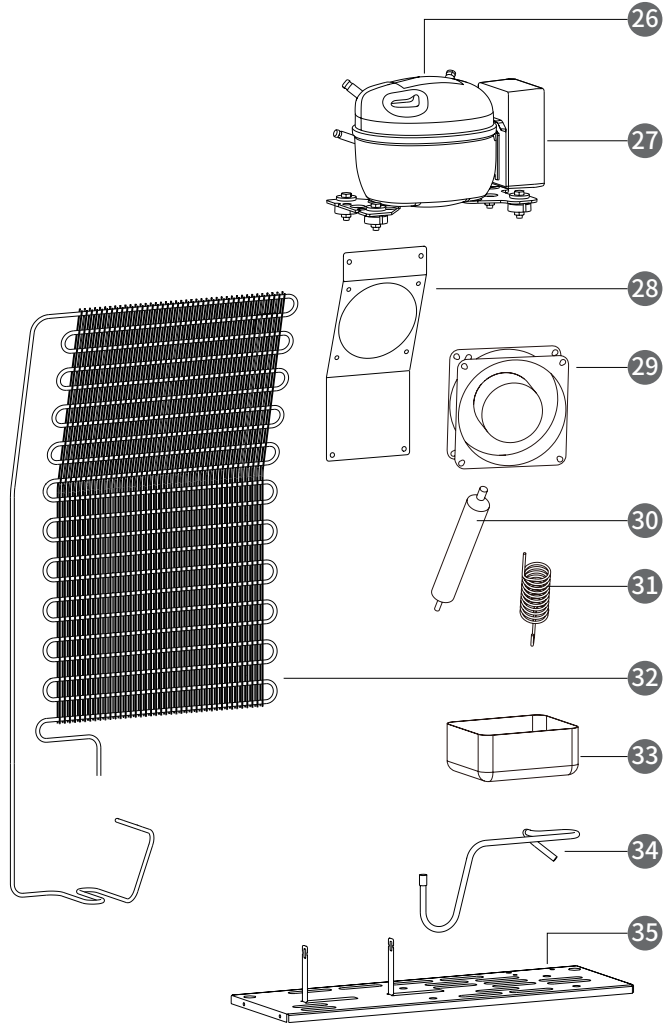

EN

Serial number	Name	Material number	Quantity
1	Upper handle blank	01.03.09040009	1
2	Freezer door	01.03.09040060	1
3	Left frame, freezer door	01.03.09040019	1
4	Handle assembly, freezer door	01.03.09040061	1
5	Handle assembly, refrigerator door	01.03.09040063	1
6	Refrigerator door	01.03.09040062	1
7	Left frame, refrigerator door	01.01.09040045	1
8	Lower handle blank	01.03.09040009	1
9	Door bin	DL05001295	2
10	Electronic unit	01.02.09040058	1
11	Control panel	01.02.09040059	1
12	Ventilation grille assembly	01.03.09040064	1
13	Right upper hinge	01.01.09040119	1
14	Upper hinge pin	01.01.09040049	1
15	Center hinge pin	01.01.09040050	1
16	Center hinge	01.01.09040122	1
17	Lower hinge pin	01.01.14540130	1
18	Right lower hinge	01.01.14540134	1

Serial number	Name	Material number	Quantity
19	Foot	DL02501219	4
20	Shelf in freezer compartment	01.01.09040092	1
21	Upper shelf in refrigerator compartment	01.01.09040081	1
22	Middle shelf in refrigerator compartment	01.01.09040093	1
23	Lower shelf in refrigerator compartment	01.01.09040094	1
24	Fruit and vegetable section	01.01.09040095	1
25	Built-in lamp	01.03.09040065	1
26	Compressor	01.02.00040217	1
27	Compressor terminal	01.02.00040217	1
28	Fan bracket	01.01.09040116	1
29	Condenser fan	DL22502297	1
30	Filter drier	01.04.04040006	1
31	Capillary	01.08.00050024	1
32	Condenser	01.04.09040003	1
33	Drip cup	DL10001155	1
34	Suction pipe	01.04.09040005	1
35	Base pan	01.01.09040115	1

12.0 Warranty

The statutory warranty period applies. If the product is defective, please contact the nearest dealer in your location. For repair and guarantee processing, please prepare the following documents:

- A copy of the invoice with purchasing date.
- A reason for the claim or description of the fault.

No warranty claim shall be applicable under the following circumstances:

- Damage, accident or otherwise, to the refrigerator while in the possession of the consumer not caused by a defect in material or workmanship.
- Damage caused by consumer misuse, tampering, or failure to follow the care and special handling provisions in the instructions.
- Damage to the finish of the case, or other appearance parts caused by wear.
- Damage caused by repairs or alterations of the refrigerator by anyone other than those authorized by the manufacturer.



All rights reserved.
ARANA TECH (Shenzhen) Co., Ltd.
reserves the right to modify at any time
without notice, prices, materials,
specifications and models or to cease
production of any model.

版权所有，侵权必究
阿雷纳科技（深圳）有限公司
保留随时修改价格、材料、规格和型号的权利
或停止任何产品型号的生产，恕不另行通知

www.arana.com.cn
服务热线：400 110 1890